



## Main Features:-

- ◆ Monoblock Ball Valve
- ◆ 1/4" to 1/2" PN63
- ◆ Thread ends according to ISO 7-1
- ◆ Working Temperature -25 to +180C \*
- ◆ Reduced Bore

\*Temperature and pressure determined by valve body, seat etc.

## Suitable Applications & Approvals:



HVAC



OIL



GAS



INDUSTRY



## SERIES: 80001

MANUFACTURER: **GENEBRE**

VALVE MATERIALS & DIMENSIONS

ITEM	SECTION	MATERIAL	ADDITIONAL INFO / OPTIONS
1	Body	Stainless Steel 1.4408	External polished.
2	Cap	Stainless Steel 1.4408	n/a
3	Gasket	PTFE	n/a
4	Ball	Stainless Steel 1.4408	n/a
5	Ball Stem	PTFE	n/a
6	Stem	AISI 316	n/a
7	Friction Ring	PTFE	n/a
8	Stem Packing	PTFE	n/a
9	Stem Ring	AISI 304	n/a
10	Washer	AISI 304	n/a
11	Nut	AISI 304	n/a
12	Handle	AISI 304	n/a

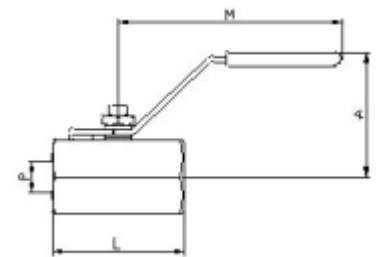
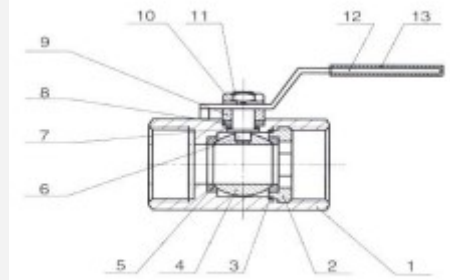

REF	SIZE	PN	P	A	L	M	Kg
80001-02	1/4"	63	5	30	40	65	70
80001-03	3/8"	63	7	30	45	82	108
80001-04	1/2"	63	9	55	57	108	168

## ALL VALVES

AllValves Online™ have used decades of experience in the valve industry to select a range of products that match the AllValves Online ethos - value for money. All Valves Products are from reputable sources and have been sold in significant quantities for many years, are installed in a wide variety of applications, and are known to be durable in service.



T +44 (0)1386 552369

E sales@allvalves.co.uk

W www.allvalves.co.uk

F +44 (0)1386



Genebre are a global brand of industrial valves with large stocks held for fast delivery on various type of valves, sizes, end connections and materials.

**SERIES: 80001**

TOI / UE / Kv VALUES / PRESSURE & TEMP CHART

REF	SIZE	TORQUE Nm	REF	SIZE	Kv	TORQUE :
80001-02	1/4"	4-5	2001-02	1/4"	3.5	<p>- The liquid listed in the table are initial breakaway torques, taken with liquids and lubricant media.</p> <p>- Please regard these as approximate values, as the objective value on different factors like pressure, medium, rubber</p>
80001-03	3/8"	4-5	2001-03	3/8"	4	
80001-04	1/2"	4-5	2001-04	1/2"	5	

## PRESSURE AND TEMPERATURE CHART GENEBRE

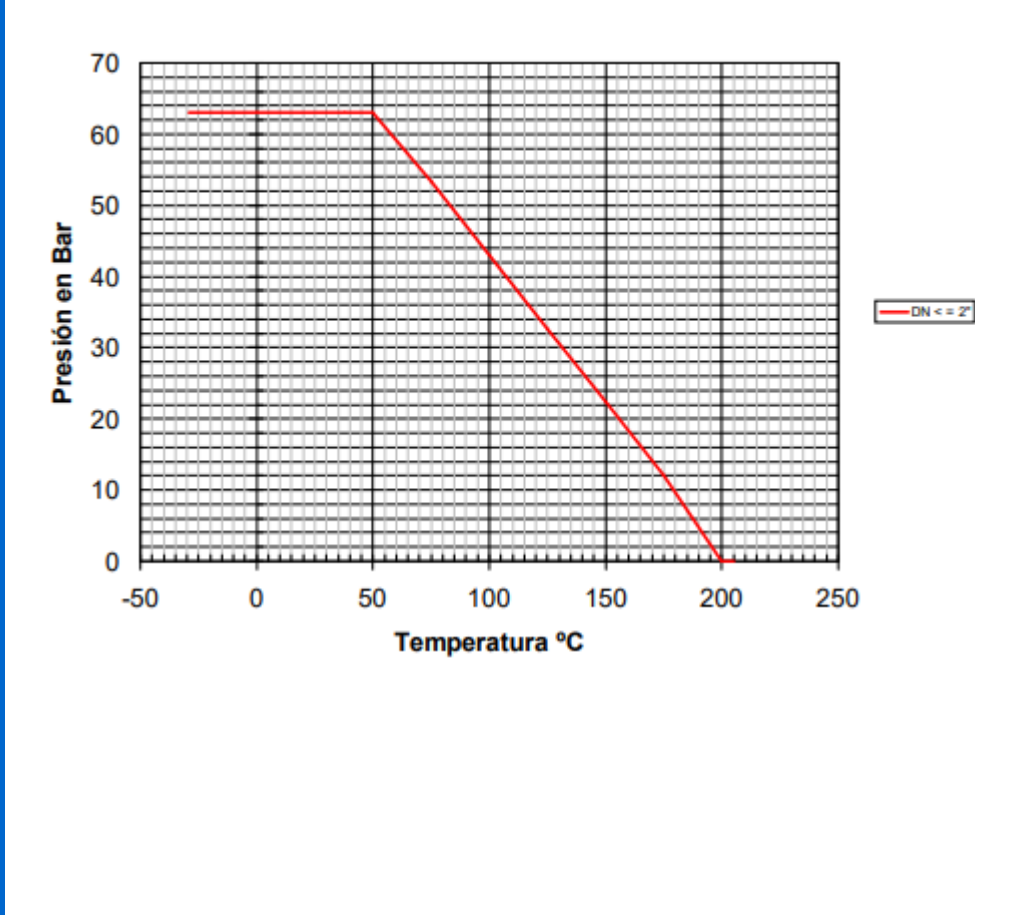

Genebre is a leading company and world reference in fluid control and high-quality taps. They control all the creation processes, responding to the specific needs of each market: from the initial concept and design of the product to the production and commercialization.

In the Industrial line of Genebre products you will find a wide range of industrial valves and their accessories, sanitary line valves, automated valves and control valves, stainless steel fittings, different elements for industrial instrumentation and all spare parts for valves sphere.

## ALL VALVES

Offering a full range of actuated valve packages, manual valve range, pipe fittings and pumps, we have a product for all your requirements. As an ISO 9001-2001 Quality Approved and certified company, All Valves offer a quality service from pre-sale to post sale. Shipping millions of pounds in value of manual valve and actuated valve packages all over the world since its formation, All Valves are a trusted valve and actuator supplier to many companies all over the world. Working with the leading brands in most industries.

